



Office of Economic Development

**Civic Arts Commission
Public Art Committee
Wednesday, January 19, 2022 at 2:30 p.m.**

**PUBLIC ADVISORY: THIS MEETING WILL BE CONDUCTED EXCLUSIVELY
THROUGH VIDEOCONFERENCE AND TELECONFERENCE**

Pursuant to Government Code Section 54953(e) and the state declared emergency, this meeting of the Civic Arts Commission will be conducted exclusively through teleconference and Zoom videoconference. The COVID-19 state of emergency continues to directly impact the ability of the members to meet safely in person and presents imminent risks to the health of attendees. Therefore, no physical meeting location will be available.

To access the meeting remotely: Join from a PC, Mac, iPad, iPhone, or Android device: Please use this URL <https://us02web.zoom.us/j/86089984060>. If you do not wish for your name to appear on the screen, then use the drop-down menu and click on "rename" to rename yourself to be anonymous. To request to speak, use the "raise hand" icon by rolling over the bottom of the screen. To join by phone: Dial **1-669-900-9128** and enter Meeting ID: **860 8998 4060**. If you wish to comment during the public comment portion of the agenda, Press *9 and wait to be recognized by the Chair.

To submit an e-mail comment during the meeting to be read aloud during public comment, email civicarts@cityofberkeley.info with the Subject Line in this format: "PUBLIC COMMENT ITEM ##." Please observe a 150-word limit. Time limits on public comments will apply.

Agenda

1. **CALL TO ORDER AND ROLL CALL**
2. **PUBLIC COMMENT**
3. **CHAIR'S REPORT**
4. **DISCUSSION ITEMS WITH POSSIBLE ACTION**
 - a) Cube Space exhibition curated by Leila Weefur – Artist Guy Leonard Reidelbach

- b) Conservation of "In Berkeley" by Nancy Selvin with shift west by approximately 1 foot (Attachment 1)
- c) Design for Berkeley Art Works Project Mural by Eduardo Pineda
- d) Design for Berkeley Art Works Project by Suzi Garner

5. STAFF REPORT

6. ADJOURNMENT

Attachments:

- 1. "In Berkeley" by Nancy Selvin

Staff Contact:

Jennifer Lovvorn

Secretary to the Civic Arts Commission

Berkeley, CA 94704

(510) 981-7533

jlovvorn@cityofberkeley.info

Communications to Berkeley boards, commissions or committees are public record and will become part of the City's electronic records, which are accessible through the City's website. **Please note: e-mail addresses, names, addresses, and other contact information are not required, but if included in any communication to a City board, commission or committee, will become part of the public record.** If you do not want your e-mail address or any other contact information to be made public, you may deliver communications via U.S. Postal Service or in person to the secretary of the relevant board, commission or committee. If you do not want your contact information included in the public record, please do not include that information in your communication. Please contact the secretary to the relevant board, commission or committee for further information.

Any writings or documents provided to a majority of the Commission regarding any item on this agenda will be made available for public inspection at the Civic Arts Office located at 2180 Milvia Street, First Floor, Berkeley, CA 94704.

ADA Disclaimer

To request a disability-related accommodation(s) to participate in the meeting, including auxiliary aids or services, please contact the Disability Services specialist at 981-6418 (V) or 981-6347 (TDD) at least three business days before the meeting date. Please refrain from wearing scented products to this meeting.



Fig. 9, The Embarcadero - San Francisco, California
415.841.2424 | fax 415.421.9284 | www.argcs.com

PREVIOUS / OLD
PAVERS LAYOUT

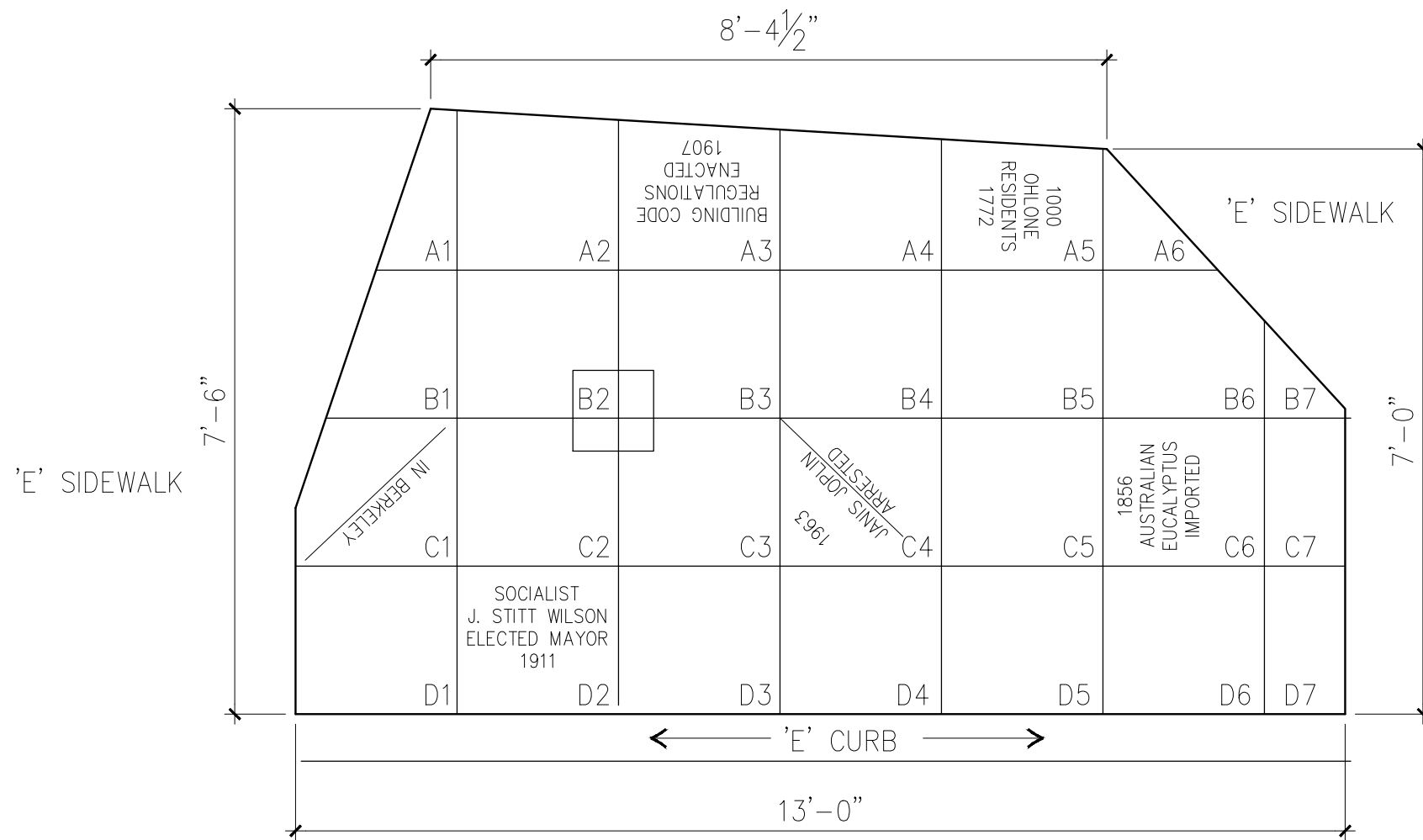

REVISED MEASUREMENT
BASED ON SITE
DIMENSION
3/2001

LOC #12
CITY OF BERKELEY
ADDISON STREETS
PUBLIC ART PROJECT
@ N. SELVIN 2001
SELVING STUDIOS
745 PAGE STREET,
BERKELEY, CA 94710

| NO. | DESCRIPTION | DATE |
|-----------|-------------|------|
| REVISIONS | | |

**BERKELEY
PAVER**
RE-FABRICATE / REDESIGN

BERKELEY, CALIFORNIA

SHEET TITLE
**PLAN -
PREVIOUS LAYOUT**

ISSUANCE
--

DATE
JANUARY 2022

| | |
|--------------------|--|
| PROJ. NO. 20044 | |
| DRAWN | |
| CHECKED | |

DRAWING NO.
A1
SHEET 1 OF 3

1 PLAN - PREVIOUS LAYOUT
A1 SCALE: 1/2" = 1'-0"
BASE DRAWINGS

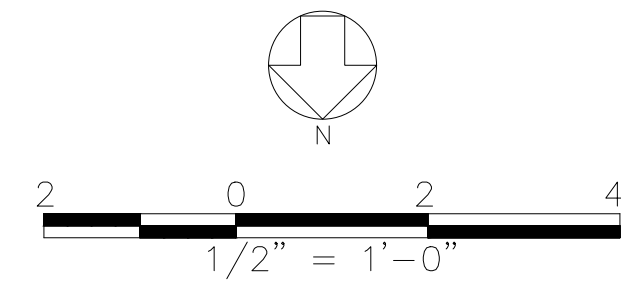

© ARG CONSERVATION SERVICES, INC.

TEXT REVISED 12/14/2020 NANCY SELVIN

UPDATED PAVERS LAYOUT

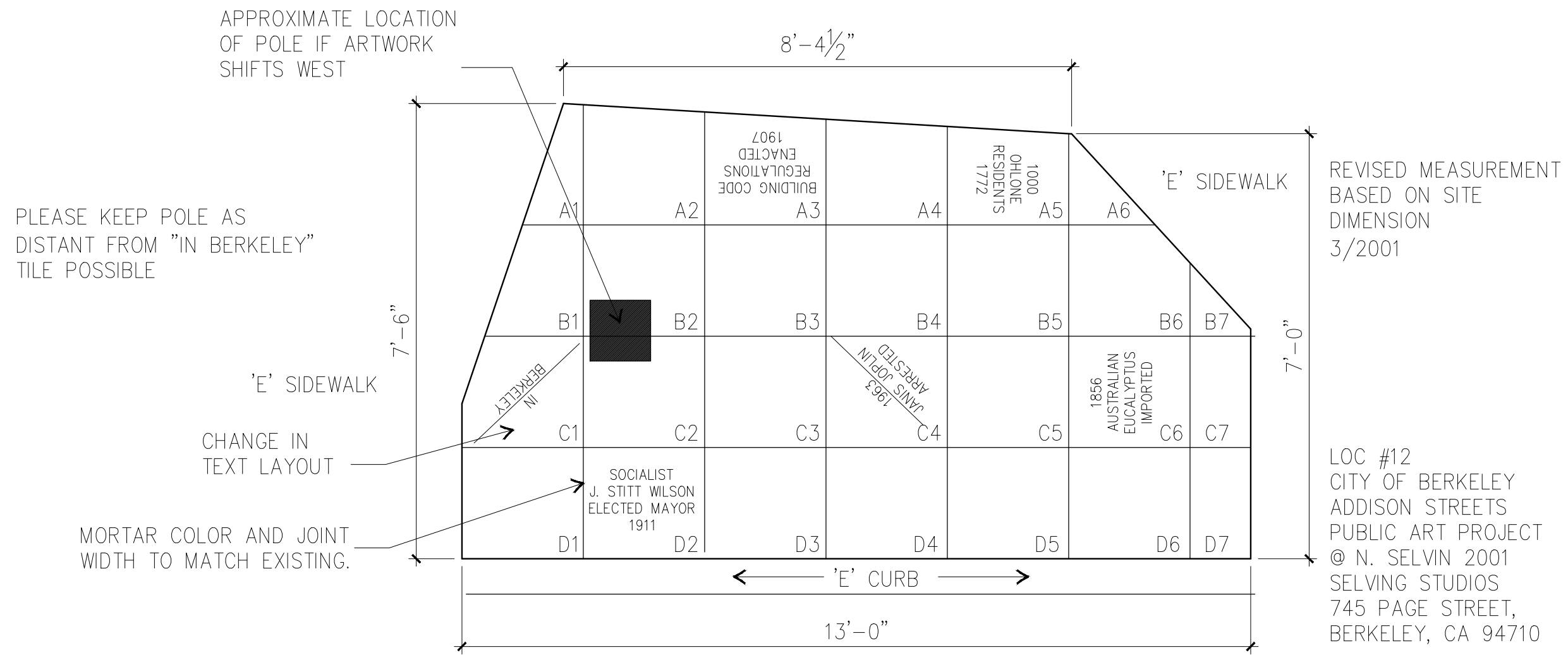

REVISED MEASUREMENT
BASED ON SITE
DIMENSION
3/2001

LOC #12
CITY OF BERKELEY
ADDISON STREETS
PUBLIC ART PROJECT
@ N. SELVIN 2001
SELVING STUDIOS
745 PAGE STREET,
BERKELEY, CA 94710



Fig. 9. The Embarcadero - San Francisco, California
415.861.2424 | Fax 415.491.9044 | www.argcs.com

| NO. | DESCRIPTION | DATE |
|-----------|-------------|------|
| REVISIONS | | |

**BERKELEY
PAVER**
RE-FABRICATE / REDESIGN

BERKELEY, CALIFORNIA

SHEET TITLE
**PLAN -
NEW LAYOUT**

ISSUANCE
--

DATE
JANUARY 2022

| | |
|--------------------|--|
| PROJ. NO. 20044 | |
| DRAWN | |
| CHECKED | |

DRAWING NO.
A2
SHEET 2 OF 3

1 PLAN - NEW LAYOUT
A2 SCALE: 1/2" = 1'-0"
BASE DRAWING

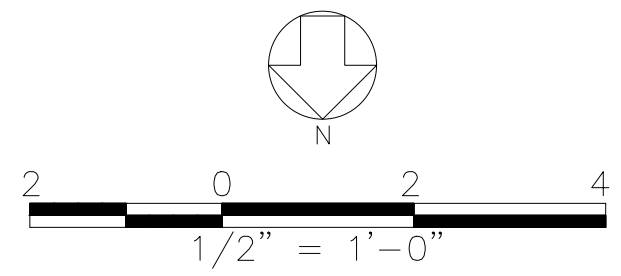

© ARG CONSERVATION SERVICES, INC.

11"x17" SHEET SIZE. IF SHEET SIZE IS SMALLER, THEN DRAWING HAS BEEN REDUCED.



Plot 9, The Embarcadero - San Francisco, California
415.861.2299 | fax 415.421.9044 | www.argcs.com

SELVIN
ADDISON STREET SITE
#12 CROSS SECTION

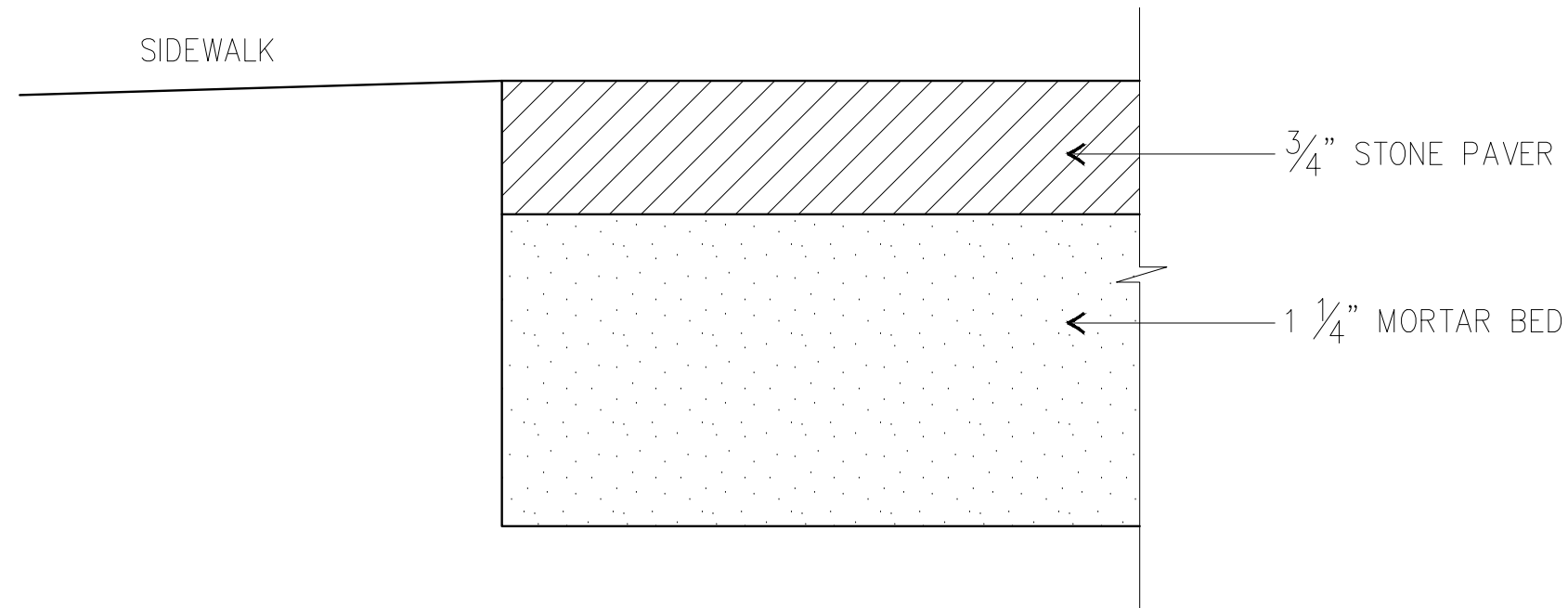

| NO. | DESCRIPTION | DATE |
|-----------|-------------|------|
| REVISIONS | | |

**BERKELEY
PAVER**
RE-FABRICATE / REDESIGN

BERKELEY, CALIFORNIA

SHEET TITLE
CROSS SECTION

ISSUANCE
--

DATE
JANUARY 2022

| | |
|--------------------|--|
| PROJ. NO. 20044 | |
| DRAWN | |
| CHECKED | |

DRAWING NO.
A3
SHEET 3 OF 3

1 CROSS SECTION FOR EXISTING SIDEWALK CUT
A3 SCALE: FULL
BASE DRAWING

